

SITE INFORMATION:

OWNER:
MANZANITA LOFTS LLC
TAX LOT
3N 10W TAX LOT 2600 + 2100
ZONING:
SR-R

LOT AREA:
146,456 SF
HOTEL AREA:
6,521 SF
CABIN AREA:
9,000 SF
MICRO CABIN AREA:
2,100 SF
ROAD/PARKING AREA:
26,479 SF

PERCENTAGE LOT COVERAGE w/ ROAD:
 $(6,521 + 9,000 + 2,100 + 26,479 \text{ SF}) / (146,456 \text{ SF}) \times 100 = 80.11\%$
PERCENTAGE LOT COVERAGE w/o ROAD:
 $(6,521 + 9,000 + 2,100 \text{ SF}) / (146,456 \text{ SF}) \times 100 = 12.03\%$

11251 SE 232nd AVE



DAMASCUS, OR 97089

MANZANITA RETREAT

TAX LOT:
3N 10W TAX LOT 2600 + 2100

SITE PLAN

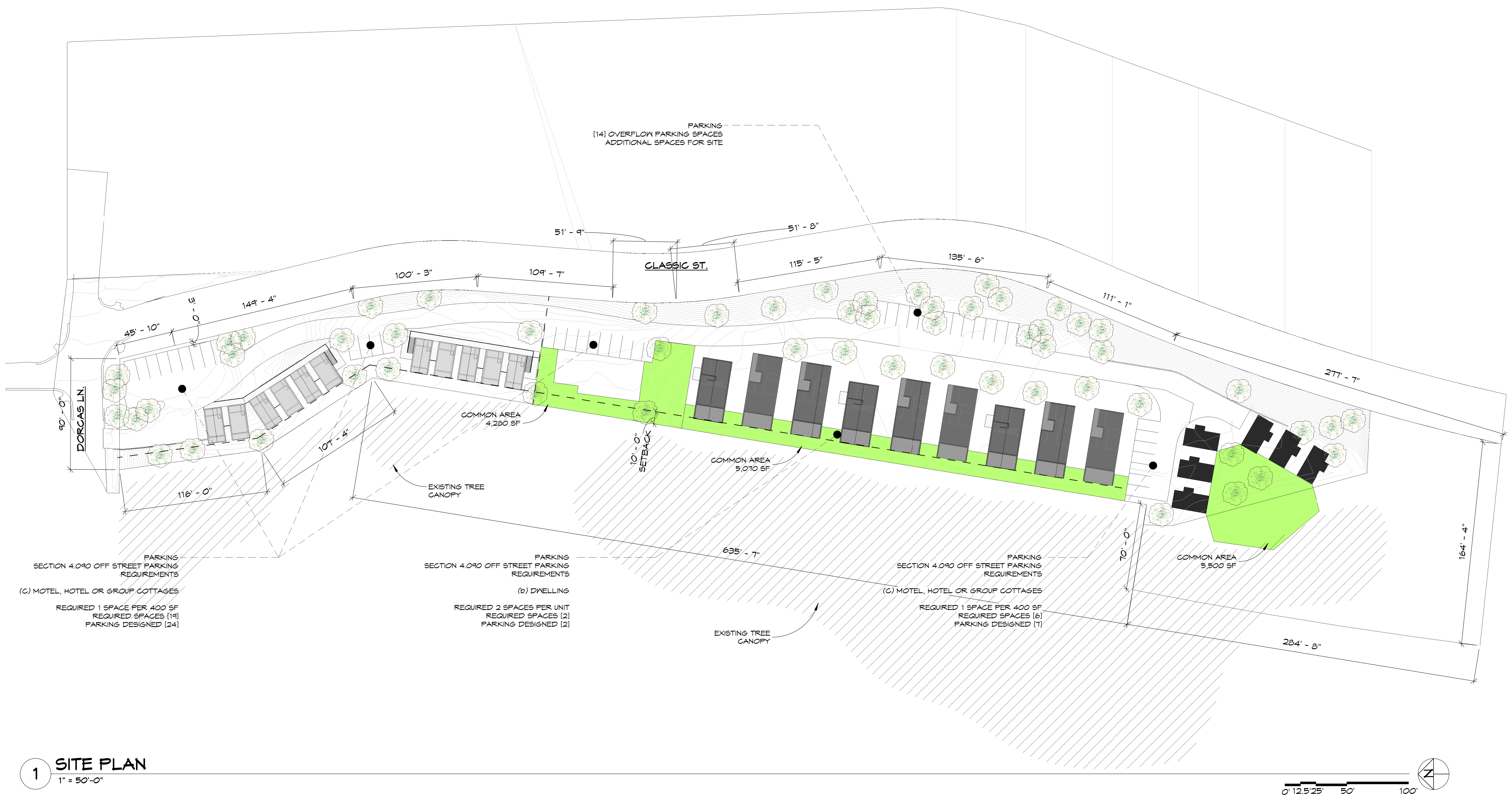

1 SITE PLAN
1" = 50'-0"

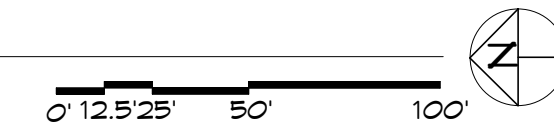

Drawn By
TL
4/29/2022 2:44:43 PM

Drawing Index		
No.	Date	Description

NOT FOR CONSTRUCTION

SITE