

LOT AREA:
146,456 SF

HOTEL AREA:
6,521 SF

CABIN AREA:
9,000 SF

MICRO CABIN AREA:
2,100 SF

ROAD/PARKING AREA:
26,479 SF

DRYWELL NOTES - HOTEL:
ROOF AREA 6,521 SF

NON TRAFFIC AREAS - INSTALL (1) 55 GAL
BARREL FOR EVERY 350 SF OF IMPERVIOUS
SURFACE.
6,521 / 350 = 18

DRYWELL NOTES - COMMON BUILDING:
ROOF AREA 2,196 SF

NON TRAFFIC AREAS - INSTALL (1) 55 GAL
BARREL FOR EVERY 350 SF OF IMPERVIOUS
SURFACE.
2,196 / 350 = 6

DRYWELL NOTES - CABINS:
ROOF AREA 9,000 SF

NON TRAFFIC AREAS - INSTALL (1) 55 GAL
BARREL FOR EVERY 350 SF OF IMPERVIOUS
SURFACE.
9000 / 350 = 25.71
1000 / 350 = 2.86 PER CABIN

DRYWELL NOTES - MICRO CABINS:
ROOF AREA 2,100 SF

NON TRAFFIC AREAS - INSTALL (1) 55 GAL
BARREL FOR EVERY 350 SF OF IMPERVIOUS
SURFACE.
2100 / 350 = 6 PER MICRO CABIN

DRYWELL NOTES - ROAD / PARKING:
AREA 24,479 SF

NON TRAFFIC AREAS - INSTALL (1) 55 GAL
BARREL FOR EVERY 350 SF OF IMPERVIOUS
SURFACE.
24,479 / 350 = 70 PER ROAD / PARKING

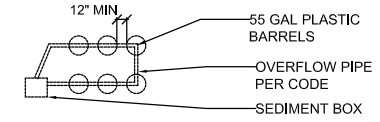

TYP. DETAIL OF DRAINAGE PER CITY OF
MANZANITA CODE

NOTE: 10' FROM STRUCTURES / 5' FROM
PROPERTY LINES

PERCENTAGE LOT COVERAGE w/ ROAD:
 $(6,521 + 9,000 + 2,100 + 26,479 \text{ SF}) / (146,456 \text{ SF}) \times 100 = 30.11\%$

PERCENTAGE LOT COVERAGE w/o ROAD:
 $(6,521 + 9,000 + 2,100 \text{ SF}) / (146,456 \text{ SF}) \times 100 = 12.03\%$

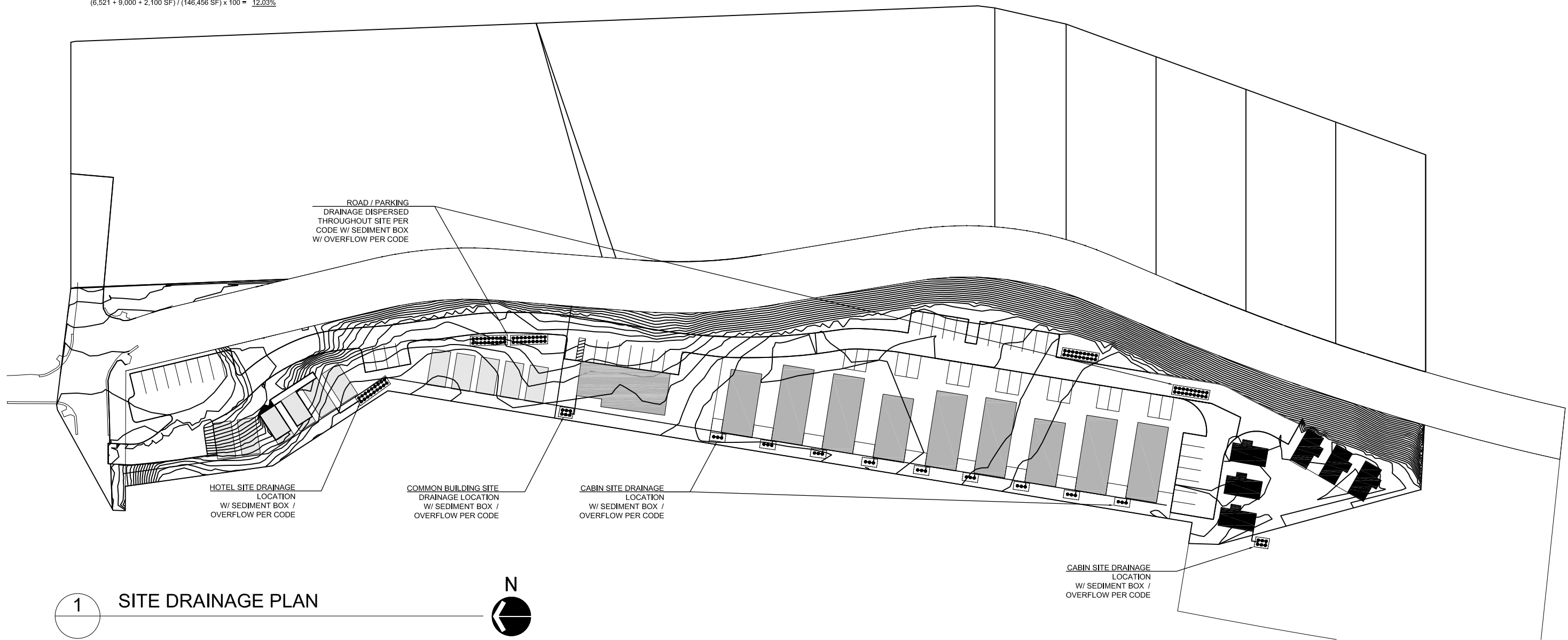

ROAD / PARKING
DRAINAGE DISPERSED
THROUGHOUT SITE PER
CODE W/ SEDIMENT BOX
W/ OVERFLOW PER CODE

HOTEL SITE DRAINAGE
LOCATION
W/ SEDIMENT BOX /
OVERFLOW PER CODE

COMMON BUILDING SITE
DRAINAGE LOCATION
W/ SEDIMENT BOX /
OVERFLOW PER CODE

CABIN SITE DRAINAGE
LOCATION
W/ SEDIMENT BOX /
OVERFLOW PER CODE

CABIN SITE DRAINAGE
LOCATION
W/ SEDIMENT BOX /
OVERFLOW PER CODE

1 SITE DRAINAGE PLAN

