

SECTION A-A

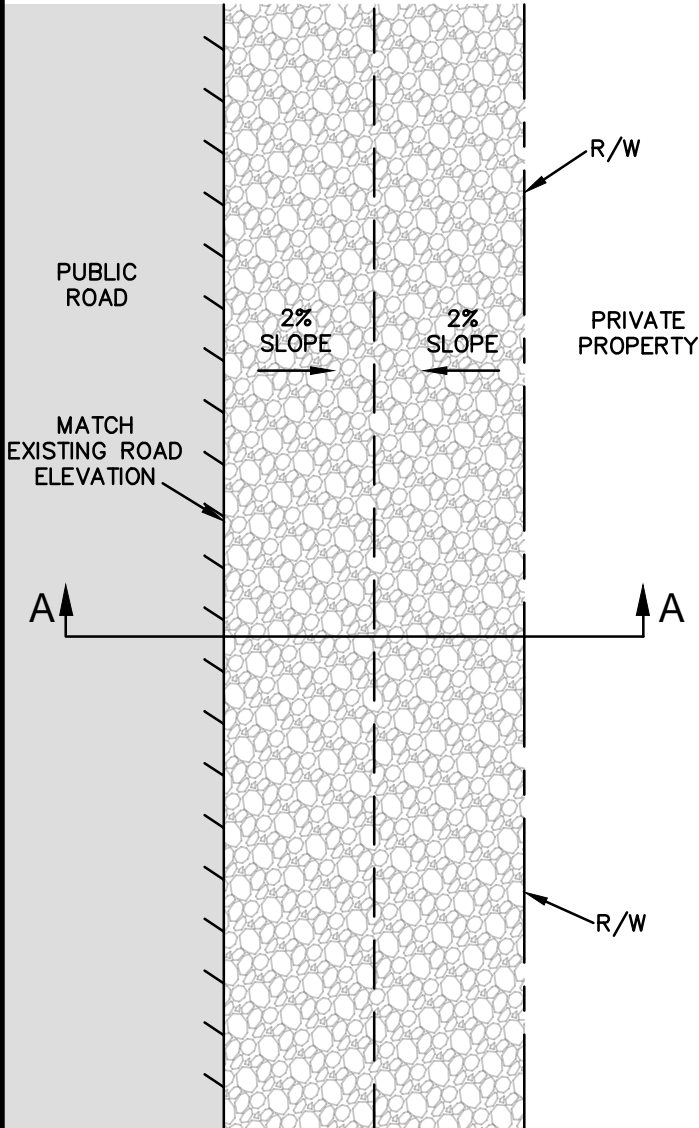

NOTES:

1. FINISH DRIVEWAY CENTERLINE ELEVATION AT PROPERTY LINE SHALL BE EQUAL WITH OR LOWER THAN ELEVATION OF STREET EDGE ASPHALT.
2. A MINIMUM 2% DOWN SLOPE IS REQUIRED FROM TRAVELED WAY/ASPHALT EDGE OF STREET.
3. DEVIATION FROM PERMIT SPECIFICATIONS REQUIRES WRITTEN PERMISSION FROM THE CITY OF MANZANITA.
4. CALL FOR FIRST INSPECTION AFTER BASE HAS BEEN PREPPED AND BEFORE FINISH COURSE HAS BEEN APPLIED. 48 HOUR PHONE NOTICE IS REQUIRED FOR INSPECTION SERVICE.
5. CALL FOR FINAL INSPECTION AFTER FINISH SURFACE HAS BEEN APPLIED.

DRAWN KKA		
ENGR. OTAK		
REV.	DATE	APPR.

CITY OF MANZANITA	
STANDARD CONSTRUCTION DRAWINGS	
CRUSHED ROCK SHOULDER	

SCALE	N.T.S.
DATE	DEC. 2015
APPR.	D.WEITZEL - PWD
DWG.	RES.ROCK.SHOULDER

PERMIT DRAWING
EXAMPLE

3rd St

Property Pin

123 3rd ST

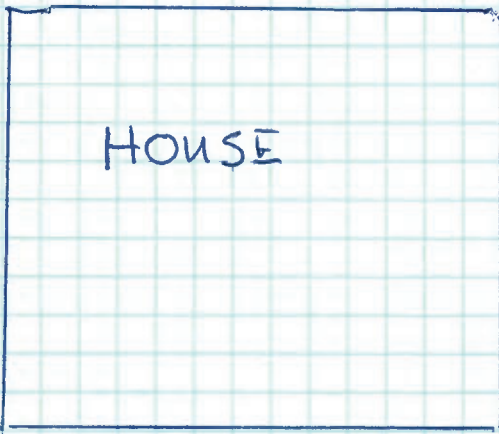

8'

NEW ASPHALT

24'

Property Pin

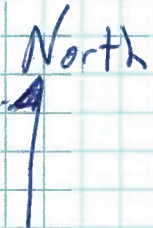

NOT TO SCALE

John Doe 503-555-5555